

Typical dishwasher Traditional construction

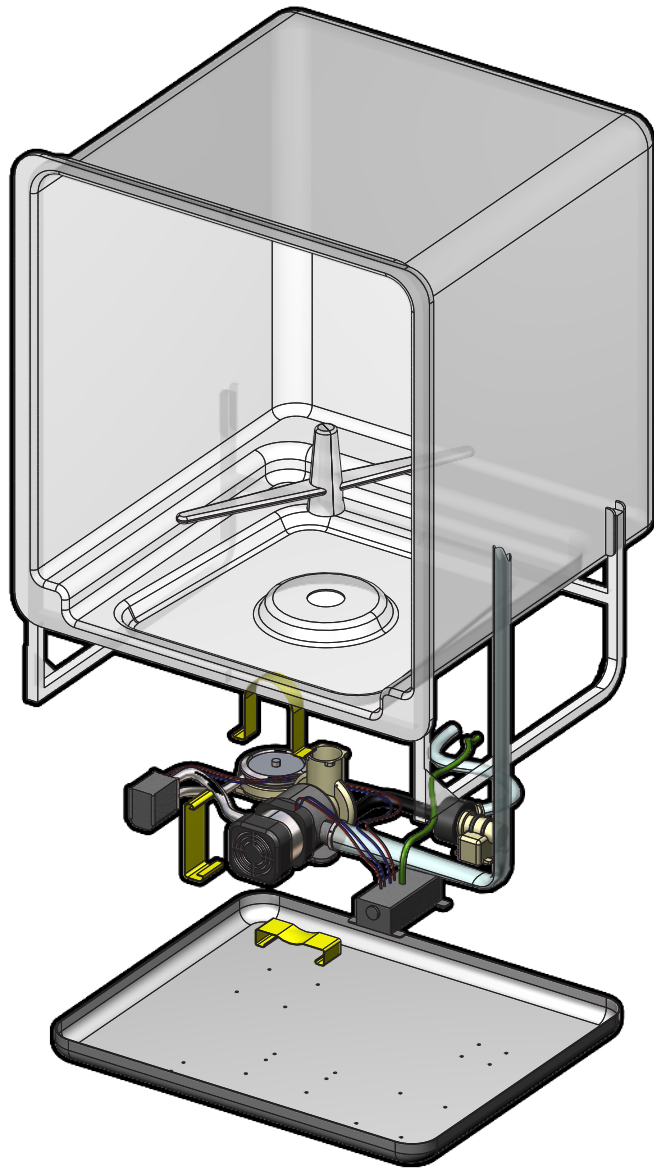

Major Components (Exploded view)

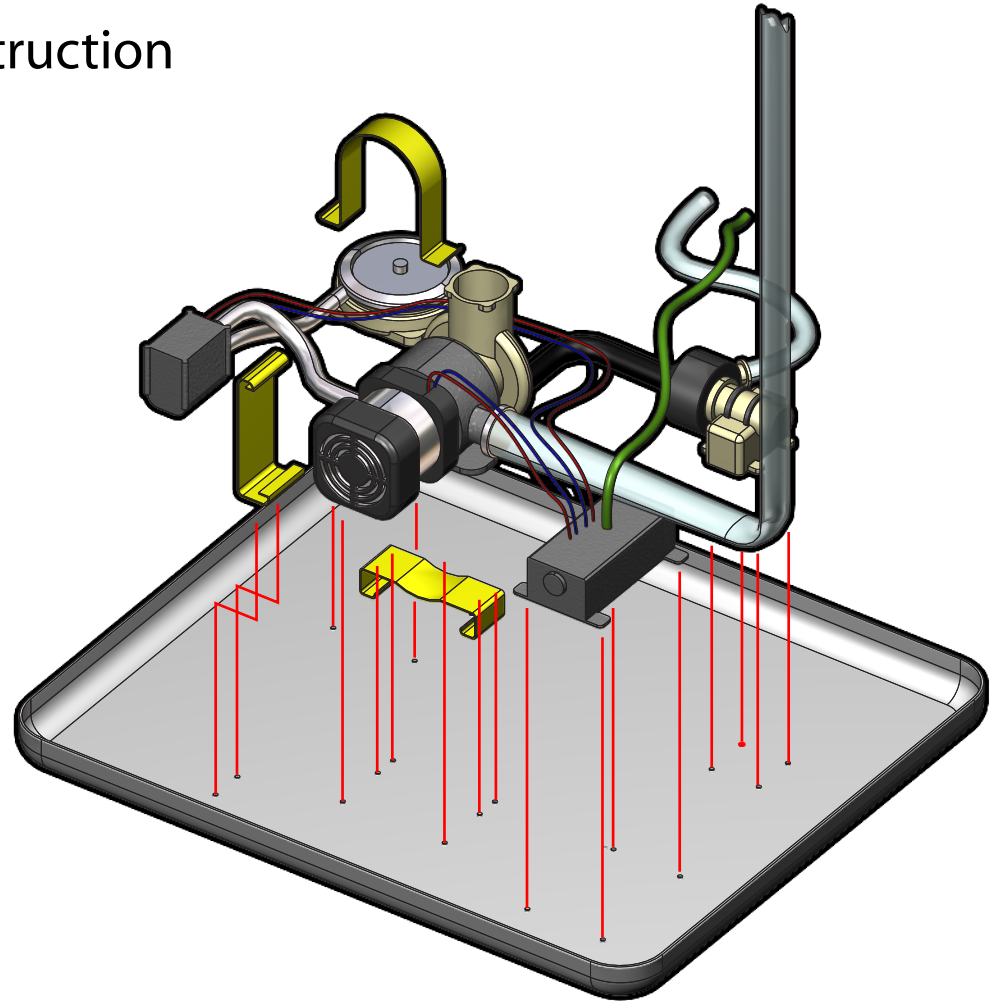

Typical dishwasher Traditional construction

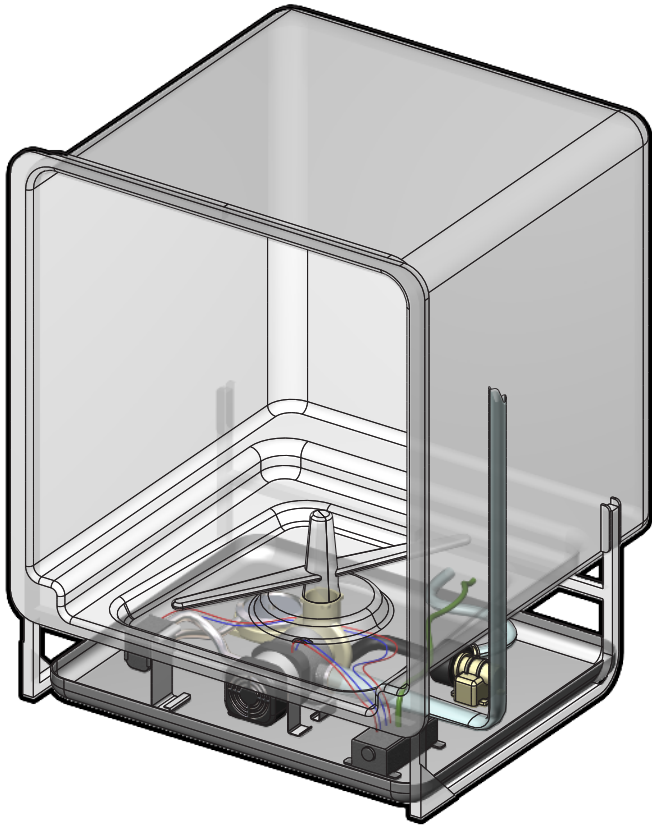

Major Components (assembled view)

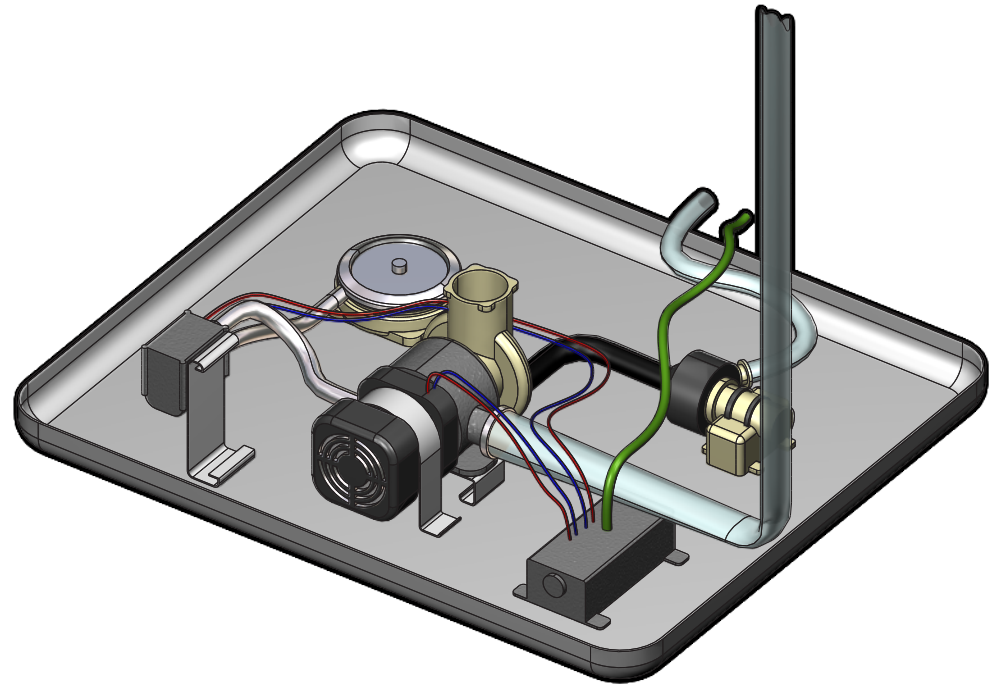

Major Components (assembled view, detail)

- 1) Labor, training, tools and extensive assembly required.
- 2) Many nuts, bolts, fasteners and clips not only have to be bought, but also inventoried, maintained, etc...
- 3) All hard mechanical connections are susceptible to wear and increasing vibration/noise.
- 4) Secondary materials are required to manage noise/vibration.

Typical dishwasher EPAC construction

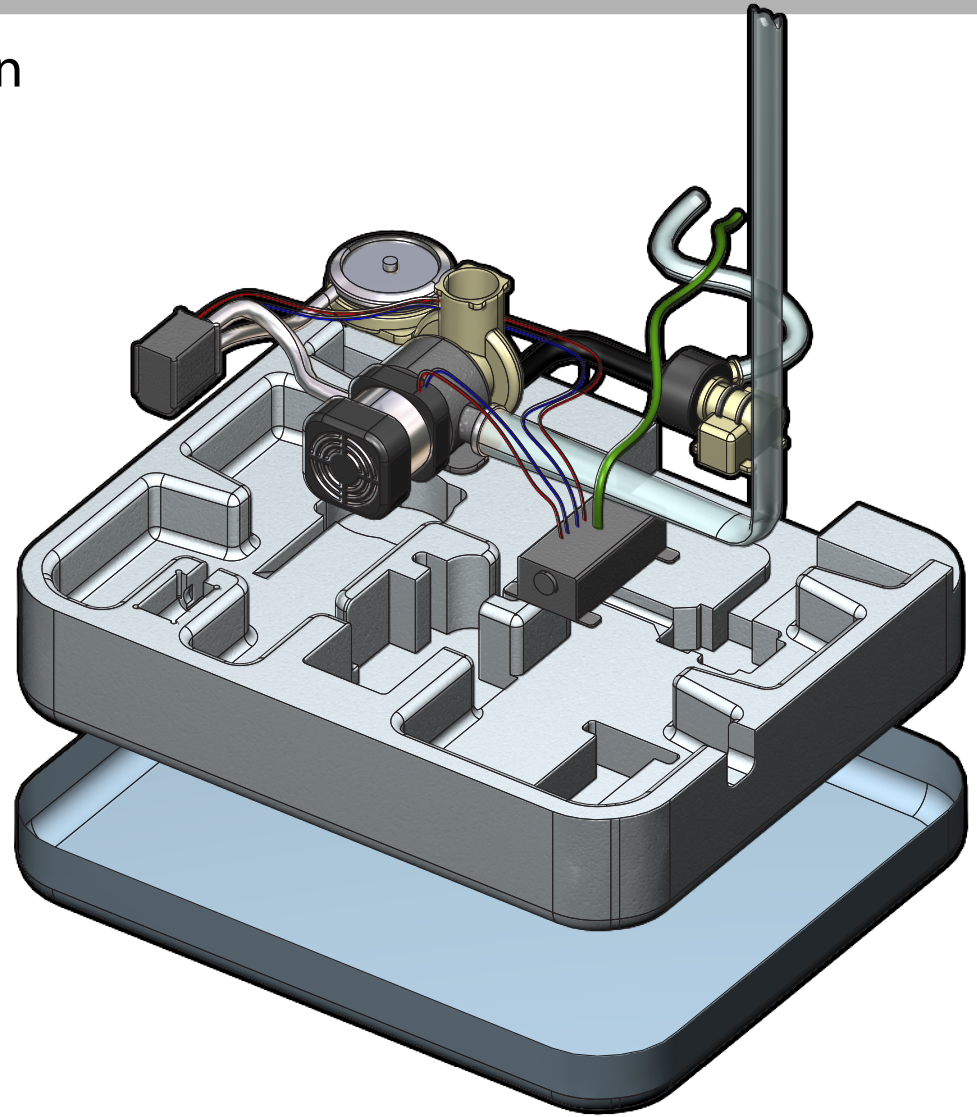
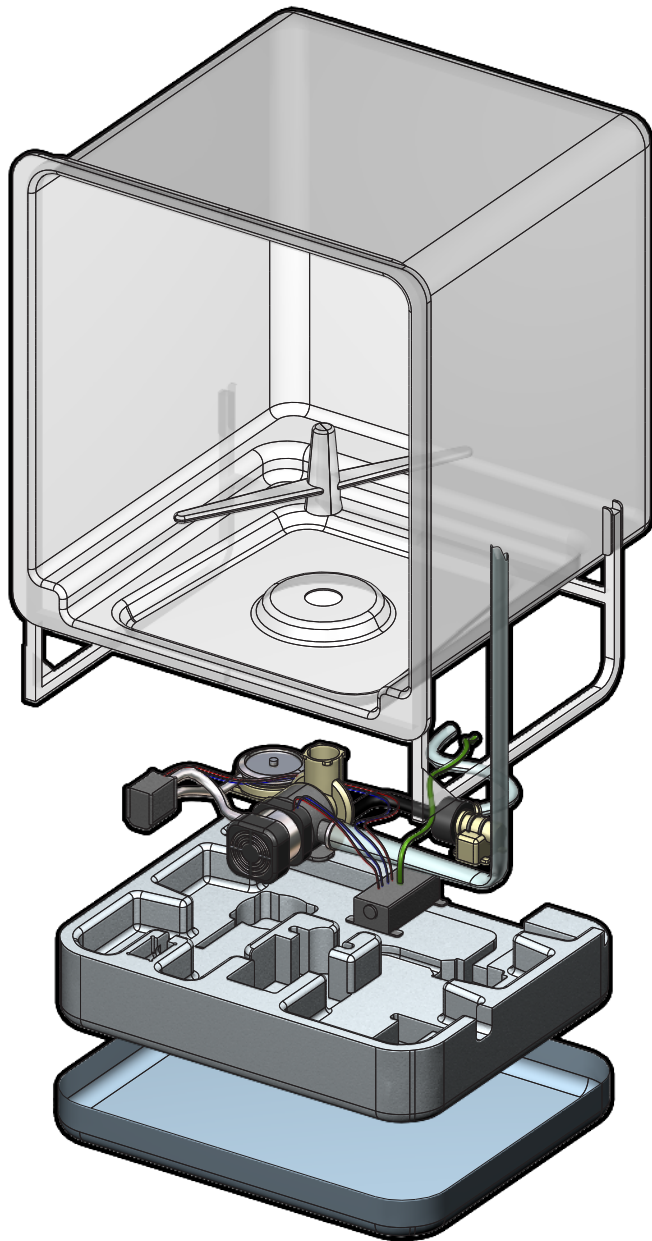

Major Components (Exploded view)

Typical dishwasher EPAC construction

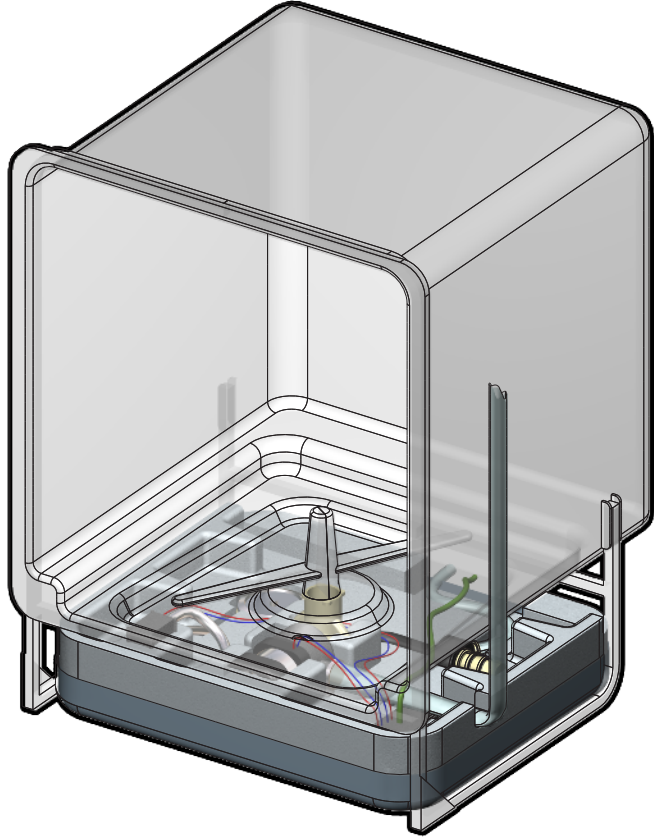

Major Components (assembled view)

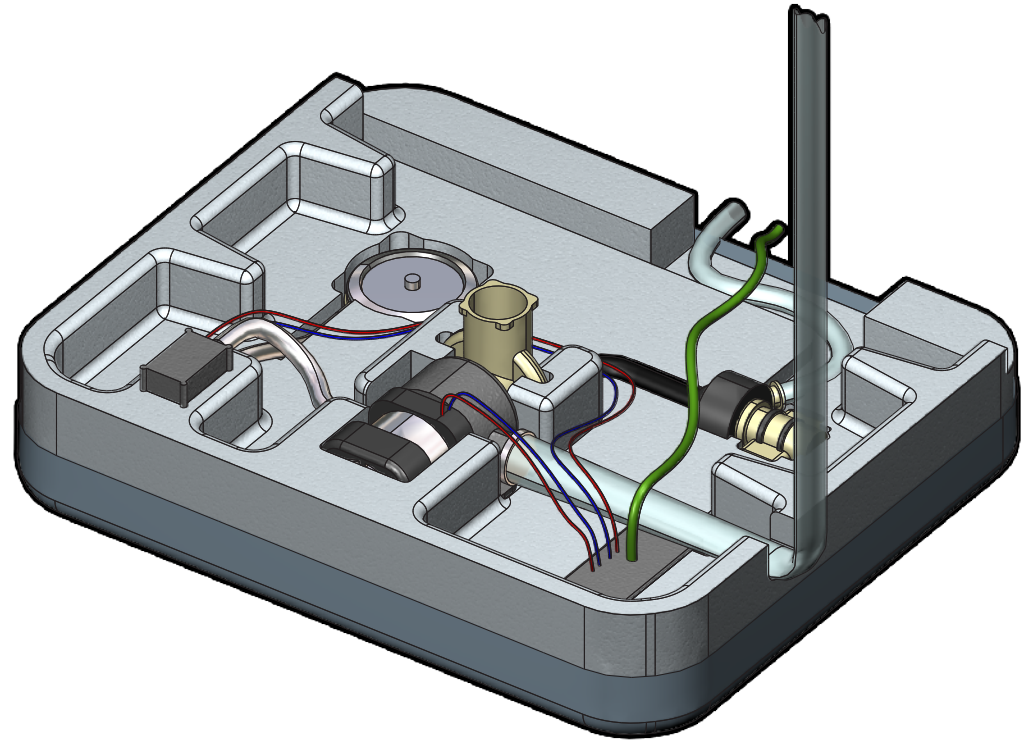

Major Components (assembled view, detail)

- 1) Assembly is "press-fit" and intuitive (like a child's puzzle).
- 2) No secondary materials, or only a few, in isolated cases...
- 3) Vibration and noise are dampened by the chassis inherent physical properties.
- 4) Pre-assembly of the whole chassis and its components is possible.
- 5) Service and recycling are easy with this concept.